

No.	Clasif.	Descripción	No.	Clas.	Description
1	SA-208	Atomizado	1	SA-208	Sprayer
2	RA-620	Dispensador p/jabón Liquido "Cerere"	2	RA-620	Liquid Soap Dispenser
3	RA-618	Empaque cepillera - Jabonera	3	RA-618	Soap Dish and Brush Holder Gasket
4	RA-633	Arillo porta - Janonera Cepillera	4	RA-633	Small Ring for Soap Dish and Brush Holder
5	RA-637	Tornillo Allen 8-32 UNC-2A X 5/16"	5	RA-637	8-32 X 5/16" Allen Screw
6	RA-669	Brazo Hexagonal Soporte Jabonera	6	RA-669	Support Hexagonal Arm for Soap Dish
7	RA-301	Opresor c/ranura 1/4"-UNC	7	RA-301	Opresor 1/4-20 UNC-2A X 3/16"
8	RA-303	Tapón Grande L/Quorum	8	RA-303	Large Quorum Cap
9	SA-148	Unión con Arillo Hexagonal	9	SA-148	Hexagonal Support Ring
10	RA-170	Chapeton P/Ancla	10	RA-170	Accessory Anchor Plate
11	RA-187	O Ring 2-137	11	RA-187	2-133 O Ring
12	RA-186	Ancla Base Imperial Roscada	12	RA-186	Threaded Imp. Anchor Base
13	SA-223	Taq. y Pijas 10-16 X 1-1/2" c/Bolsa	13	SA-223	Plastic Shield and Lag Screw Set

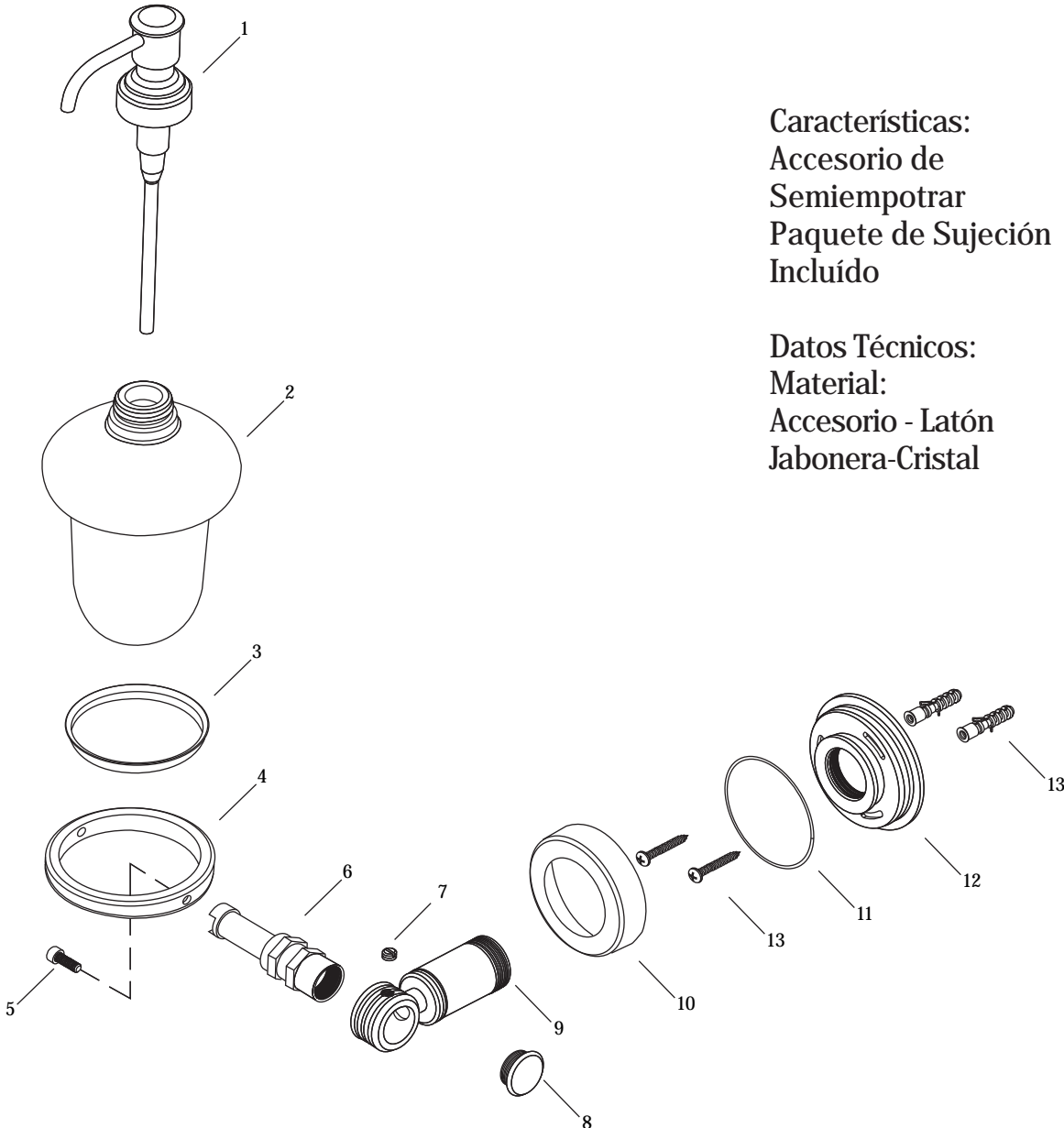

Características:
Accesorio de
Semiempotrar
Paquete de Sujeción
Incluido

Features:
*Wall Mounted Accessory
Setting Kit Included*

Datos Técnicos:
Material:
Accesorio - Latón
Jabonera-Cristal

Technical Information:
Material:
*Accesorie-Brass
Soap Dish- Crystal*